

IMT WOOD RANCH

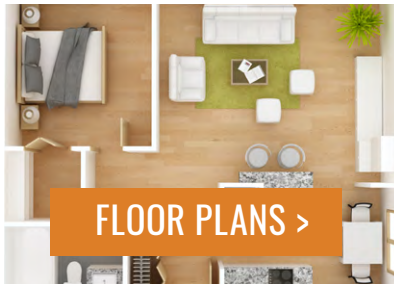

MAKE THIS HOME YOURS

Learn about our amenities, neighborhood and living elements that will make the perfect home for you:



[FLOOR PLANS >](#)



[GALLERY >](#)



[SITE MAP >](#)



[AMENITIES >](#)



[NEIGHBORHOOD >](#)



[APPLY NOW >](#)

IMT WOOD RANCH

 643 Country Club Dr • Simi Valley, CA 93065

Call/Text: 805.222.7554 • imtWoodRanch.com



imt
RESIDENTIAL

COMMUNITY INFO

FEES

Application Fee: \$45

SECURITY DEPOSIT

One Bedroom: \$400

Two Bedroom: \$600

UTILITIES, ETC.

Renters Insurance: Required

Water: Calleguas

Electric: SCE

Cable/Internet: Your choice

Trash Fee: Varies

Package Lockers:

Initial Fee: \$20, No monthly fee

PETS

Pet Deposit (Refundable):
\$500 (Covers up to 2 pets)

Pet Fee (Non-Refundable):
\$50 (per pet)

Pet Information:
Two pets allowed per home;
no weight limit;
breed restrictions enforced.

Security deposit on approved credit only. Prices are subject to change daily. Apartments cannot be reserved without application and app/admin payment.

MY IMT RESIDENT PORTAL

Live worry-free, knowing that we're committed to providing you the information and services you need to ensure your living experience exceeds your expectations.



ONLINE PORTAL

Login at Myimt.imtResidential.com



ON-SITE KIOSK

Digital touch-screen located at the community



RENT PAYMENTS

Securely pay your rent online as a one-time or recurring transaction with your credit card or checking account.



SERVICE REQUESTS

Instantly notify us of any items in need of attention and the service team will contact you promptly to schedule an appointment.



AMENITY RESERVATIONS

Enjoy our amenities responsibly and maintain social distancing by reserving your spot with an amenity pass.



COMMUNITY POSTINGS

Easily post general announcements, items for sale, or offered services to the entire community for all your neighbors to see.

GET SOCIAL

FOLLOW US ON:



REVIEW US ON:



IMT WOOD RANCH

 643 Country Club Dr • Simi Valley, CA 93065

Call/Text: 805.222.7554 • imtWoodRanch.com

